



FOR LEASE - 7,412 SF FORMER CALIFORNIA PATIO ENCINITAS RANCH TOWN CENTER

(This Building Under Separate Ownership)
SWC El Camino Real & Leucadia Blvd
Encinitas, California



FEATURES

- Major commercial intersecting arterials
- Affluent trade area population
- Easy access, strong visibility, good parking and signage
- A part of Encinitas Ranch Town Center, but separate ownership

CLOSE TO



DEMOGRAPHICS

	1 Mile	3 Mile	5 Mile
2006 Population:	10,596	79,931	129,110
2011 Proj Pop:	11,910	84,778	139,756
Avg HH Income:	\$121,347	\$113,804	\$120,540

TRAFFIC COUNTS

(GoogleEarth 2010)

El Camino Real South of Leucadia Blvd	52,722 ADT
Leucadia Blvd West of El Camino Real	30,732 ADT

DON MOSER
Lic.# 00821359
858.523.2087
dmoser@retailinsite.net

A MEMBER OF
CHAINLINKS
RETAIL ADVISORS

The information above has been obtained from sources believed to be reliable. While we do not doubt its accuracy, we have not verified it and make no guarantee, warranty or representation about it. It is your responsibility to independently confirm its accuracy and completeness. Any projections, opinions, assumptions or estimates used are for example only and do not represent the current or future performance of the property. The value of this transaction to you depends on tax and other factors which should be evaluated by your tax, financial and legal advisors. You and your advisors should conduct a careful, independent investigation of the property to determine to your satisfaction the suitability of the property for your needs.

RETAIL INSITE

12264 EL CAMINO REAL STE. 202 SAN DIEGO, CA 92130
LIC # 01206760 | F: 858 523 2095 | RETAILINSITE.NET



FOR LEASE - 7,412 SF FORMER CALIFORNIA PATIO ENCINITAS RANCH TOWN CENTER

(This Building Under Separate Ownership)
SWC El Camino Real & Leucadia Blvd
Encinitas, California

SITE PLAN



DON MOSER
Lic.# 00821359
858.523.2087
dmoser@retailinsite.net

RETAIL INSITE

12264 EL CAMINO REAL STE. 202 SAN DIEGO, CA 92130
LIC # 01206760 | F: 858 523 2095 | RETAILINSITE.NET

A MEMBER OF
CHAINLINKS
RETAIL ADVISORS

The information above has been obtained from sources believed to be reliable. While we do not doubt its accuracy, we have not verified it and make no guarantee, warranty or representation about it. It is your responsibility to independently confirm its accuracy and completeness. Any projections, opinions, assumptions or estimates used are for example only and do not represent the current or future performance of the property. The value of this transaction to you depends on tax and other factors which should be evaluated by your tax, financial and legal advisors. You and your advisors should conduct a careful, independent investigation of the property to determine to your satisfaction the suitability of the property for your needs.



FOR LEASE - 7,412 SF FORMER CALIFORNIA PATIO ENCINITAS RANCH TOWN CENTER

(This Building Under Separate Ownership)
SWC El Camino Real & Leucadia Blvd
Encinitas, California

FLOOR PLAN

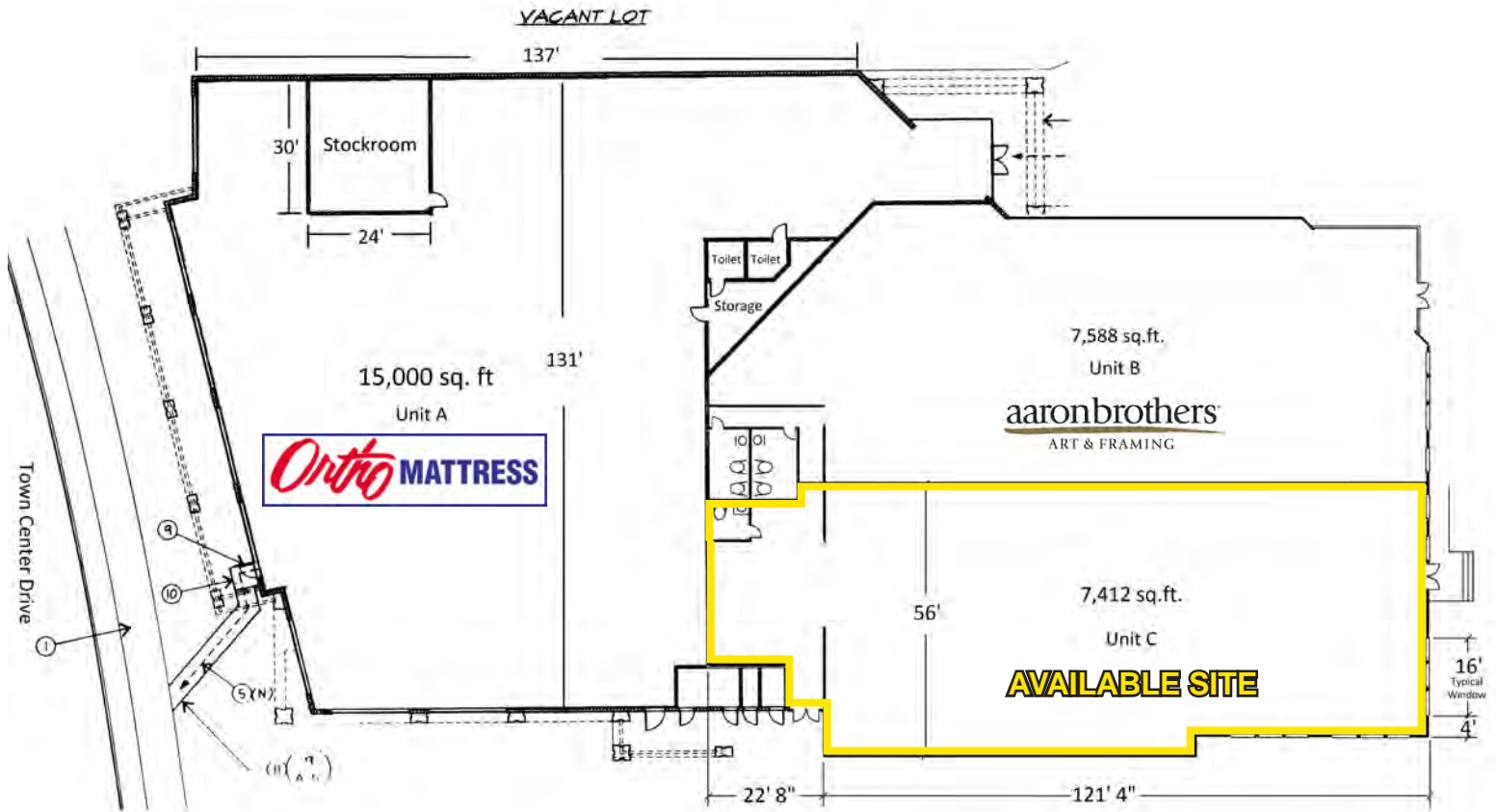

DON MOSER
Lic.# 00821359
858.523.2087
dmoser@retailinsite.net

RETAIL INSITE

12264 EL CAMINO REAL STE. 202 SAN DIEGO, CA 92130
LIC # 01206760 | F: 858 523 2095 | RETAILINSITE.NET

A MEMBER OF
CHAINLINKS
RETAIL ADVISORS

The information above has been obtained from sources believed to be reliable. While we do not doubt its accuracy, we have not verified it and make no guarantee, warranty or representation about it. It is your responsibility to independently confirm its accuracy and completeness. Any projections, opinions, assumptions or estimates used are for example only and do not represent the current or future performance of the property. The value of this transaction to you depends on tax and other factors which should be evaluated by your tax, financial and legal advisors. You and your advisors should conduct a careful, independent investigation of the property to determine to your satisfaction the suitability of the property for your needs.

ENCINITAS

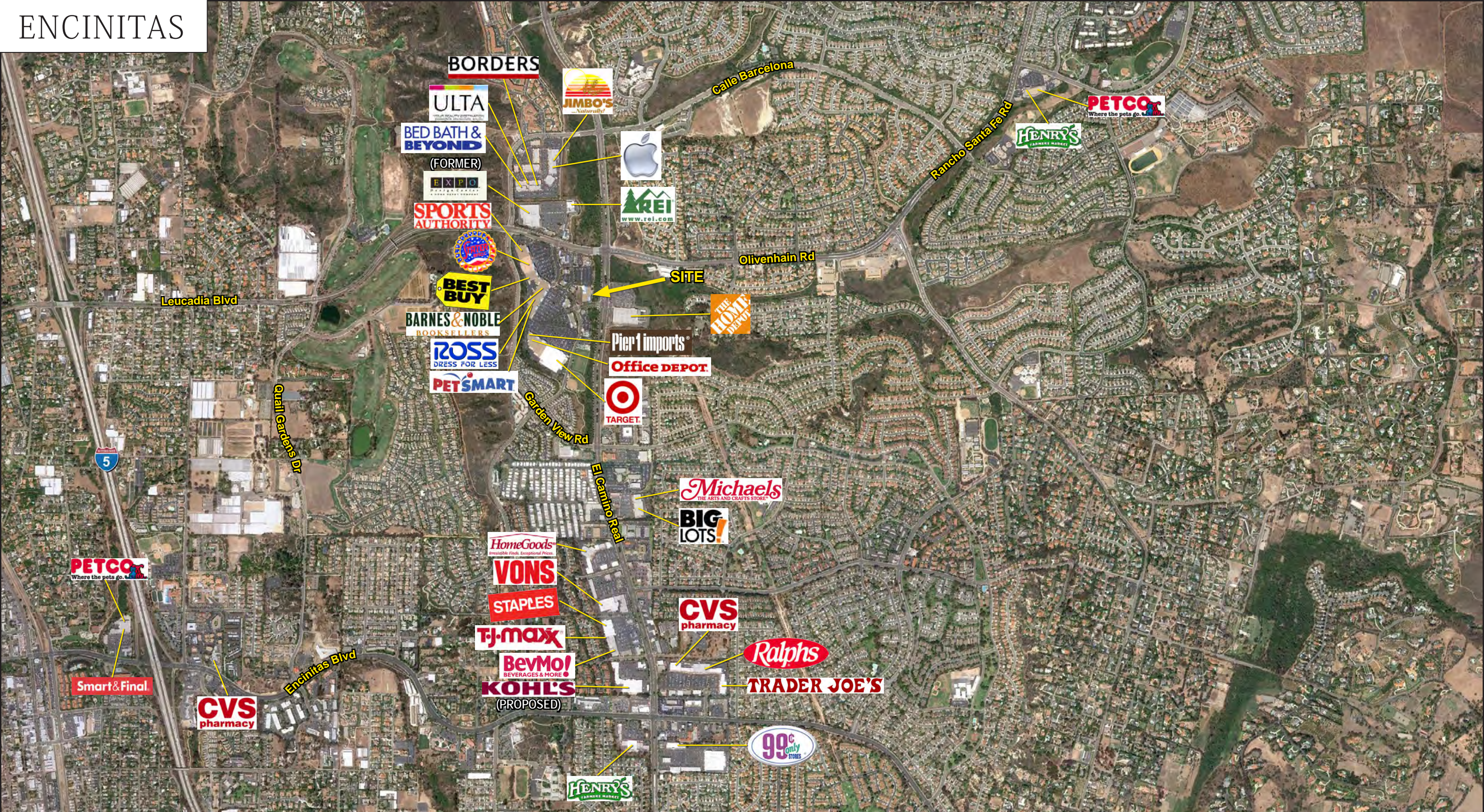

The projects, tenants and site plans illustrated herein are subject to change without notice. You and your advisors should conduct a careful, independent investigation of the information herein to determine to your satisfaction the accuracy. y/files/Aerials 2011/Encinitas Ranch Town Center.pdf



RETAIL INSITE

12264 EL CAMINO REAL STE. 202
 SAN DIEGO, CA 92130
 858.523.2090

WWW.RETAILINSITE.NET

DEMOGRAPHIC PROFILE EXPANDED

1990 - 2000 Census, 2006 Estimates & 2011 Projections

Calculated using Proportional Block Groups



Lat/Lon: 33.067585/-117.262207

RF5

N El Camino Real & Leucadia Blvd Encinitas, California	1.00 mi radius	3.00 mi radius	5.00 mi radius
Population			
Estimated Population (2006)	10,596	79,931	129,110
Census Population (1990)	7,432	64,259	94,933
Census Population (2000)	8,962	74,035	114,991
Projected Population (2011)	11,910	84,778	139,756
Forecasted Population (2016)	12,167	90,346	148,808
Historical Annual Growth (1990 to 2000)	1,530 2.1%	9,775 1.5%	20,058 2.1%
Historical Annual Growth (2000 to 2006)	1,635 3.0%	5,897 1.3%	14,119 2.0%
Projected Annual Growth (2006 to 2011)	1,313 2.5%	4,846 1.2%	10,647 1.6%
Est. Population Density (2006)	3,378.97 <i>psm</i>	3,056.53 <i>psm</i>	2,127.85 <i>psm</i>
Trade Area Size	3.14 <i>sq mi</i>	26.15 <i>sq mi</i>	60.68 <i>sq mi</i>
Households			
Estimated Households (2006)	3,725	30,756	50,982
Census Households (1990)	2,493	24,000	36,909
Census Households (2000)	3,165	28,721	45,865
Projected Households (2011)	4,187	32,514	54,971
Forecasted Households (2016)	3,884	32,094	54,257
Households with Children (2006)	1,565 42.0%	9,926 32.3%	15,749 30.9%
Average Household Size (2006)	2.81	2.58	2.52
Average Household Income			
Est. Average Household Income (2006)	\$111,127	\$105,215	\$112,288
Proj. Average Household Income (2011)	\$121,347	\$113,804	\$120,540
Average Family Income (2006)	\$122,853	\$123,531	\$132,519
Median Household Income			
Est. Median Household Income (2006)	\$101,947	\$85,809	\$91,836
Proj. Median Household Income (2011)	\$111,707	\$94,178	\$100,221
Median Family Income (2006)	\$114,848	\$103,899	\$112,949
Per Capita Income			
Est. Per Capita Income (2006)	\$39,689	\$40,889	\$44,698
Proj. Per Capita Income (2011)	\$43,333	\$44,109	\$47,814
Per Capita Income Est. 5 year change	\$3,644 9.2%	\$3,220 7.9%	\$3,116 7.0%
Other Income			
Est. Median Disposable Income (2006)	\$79,972	\$68,499	\$73,633
Est. Median Disposable Income (2011)	\$86,678	\$74,429	\$79,392
Disposable Income Est. 5 year change	\$6,706 8.4%	\$5,929 8.7%	\$5,759 7.8%
Est. Median Household Net Worth (2006)	\$62,542	\$54,708	\$55,575
Daytime Demos			
Total Number of Businesses (2006)	576	3,794	6,495
Total Number of Employees (2006)	4,301	26,208	54,278
Company Headqtrs: Businesses (2006)	0 0	5 0.1%	38 0.6%
Company Headqtrs: Employees (2006)	0 0	179 0.7%	2,786 5.1%
Unemployment Rate (2006)	0.60%	1.70%	1.60%
Employee Population per Business	7.5 to 1	6.9 to 1	8.4 to 1
Residential Population per Business	18.4 to 1	21.1 to 1	19.9 to 1

This report was produced using data from private and government sources deemed to be reliable. The information herein is provided without representation or warranty.

DEMOGRAPHIC PROFILE EXPANDED

1990 - 2000 Census, 2006 Estimates & 2011 Projections

Calculated using Proportional Block Groups



Lat/Lon: 33.067585/-117.262207

RF5

N El Camino Real & Leucadia Blvd Encinitas, California		1.00 mi radius		3.00 mi radius		5.00 mi radius	
Race & Ethnicity							
White (2006)	9,506	89.7%	70,404	88.1%	113,979	88.3%	
Black or African American (2006)	70	0.7%	682	0.9%	1,268	1.0%	
American Indian & Alaska Native (2006)	18	0.2%	209	0.3%	300	0.2%	
Asian (2006)	636	6.0%	3,759	4.7%	6,404	5.0%	
Hawaiian & Pacific Islander (2006)	11	0.1%	119	0.1%	182	0.1%	
Other Race (2006)	158	1.5%	3,029	3.8%	4,142	3.2%	
Two or More Races (2006)	198	1.9%	1,729	2.2%	2,835	2.2%	
Not Hispanic or Latino Population (2006)	9,452	89.2%	66,666	83.4%	109,742	85.0%	
Hispanic or Latino Population (2006)	1,145	10.8%	13,266	16.6%	19,367	15.0%	
Not of Hispanic Origin Population (1990)	6,646	89.4%	55,533	86.4%	83,675	88.1%	
Hispanic Origin Population (1990)	786	10.6%	8,726	13.6%	11,258	11.9%	
Not Hispanic or Latino Population (2000)	8,378	93.5%	64,716	87.4%	102,485	89.1%	
Hispanic or Latino Population (2000)	584	6.5%	9,319	12.6%	12,506	10.9%	
Not Hispanic or Latino Population (2011)	10,243	86.0%	68,269	80.5%	114,614	82.0%	
Hispanic or Latino Population (2011)	1,667	14.0%	16,509	19.5%	25,142	18.0%	
Hist. Hispanic Ann Growth (1990 to 2006)	359	2.9%	4,539	3.3%	8,109	4.5%	
Proj. Hispanic Ann Growth (2006 to 2011)	522	9.1%	3,243	4.9%	5,775	6.0%	
Age Distribution							
Age 0 to 4 yrs (2006)	858	8.1%	5,413	6.8%	8,933	6.9%	
Age 5 to 9 yrs (2006)	828	7.8%	5,199	6.5%	8,269	6.4%	
Age 10 to 14 yrs (2006)	885	8.4%	5,533	6.9%	8,548	6.6%	
Age 15 to 19 yrs (2006)	693	6.5%	4,758	6.0%	7,003	5.4%	
Age 20 to 24 yrs (2006)	342	3.2%	3,287	4.1%	4,951	3.8%	
Age 25 to 29 yrs (2006)	427	4.0%	4,540	5.7%	7,216	5.6%	
Age 30 to 34 yrs (2006)	632	6.0%	5,621	7.0%	9,221	7.1%	
Age 35 to 39 yrs (2006)	888	8.4%	6,485	8.1%	10,371	8.0%	
Age 40 to 44 yrs (2006)	1,045	9.9%	7,355	9.2%	11,576	9.0%	
Age 45 to 49 yrs (2006)	1,111	10.5%	7,969	10.0%	12,187	9.4%	
Age 50 to 54 yrs (2006)	929	8.8%	6,971	8.7%	10,953	8.5%	
Age 55 to 59 yrs (2006)	559	5.3%	4,954	6.2%	8,350	6.5%	
Age 60 to 64 yrs (2006)	348	3.3%	3,195	4.0%	5,553	4.3%	
Age 65 to 74 yrs (2006)	447	4.2%	4,111	5.1%	7,609	5.9%	
Age 75 to 84 yrs (2006)	355	3.3%	3,017	3.8%	5,755	4.5%	
Age 85 yrs plus (2006)	249	2.4%	1,525	1.9%	2,612	2.0%	
Median Age (2006)	37.9	yrs	38.6	yrs	39.5	yrs	
Gender Age Distribution							
Female Population (2006)	5,483	51.7%	40,670	50.9%	66,082	51.2%	
Age 0 to 19 yrs (2006)	1,600	29.2%	10,121	24.9%	15,916	24.1%	
Age 20 to 64 yrs (2006)	3,228	58.9%	25,480	62.7%	40,957	62.0%	
Age 65 yrs plus (2006)	655	12.0%	5,069	12.5%	9,209	13.9%	
Female Median Age (2006)	39.3	yrs	39.7	yrs	40.4	yrs	
Male Population (2006)	5,114	48.3%	39,261	49.1%	63,028	48.8%	
Age 0 to 19 yrs (2006)	1,665	32.6%	10,781	27.5%	16,837	26.7%	
Age 20 to 64 yrs (2006)	3,052	59.7%	24,895	63.4%	39,423	62.5%	
Age 65 yrs plus (2006)	396	7.8%	3,584	9.1%	6,767	10.7%	
Male Median Age (2006)	36.7	yrs	37.6	yrs	38.5	yrs	

This report was produced using data from private and government sources deemed to be reliable. The information herein is provided without representation or warranty.

DEMOGRAPHIC PROFILE EXPANDED

1990 - 2000 Census, 2006 Estimates & 2011 Projections

Calculated using Proportional Block Groups



Lat/Lon: 33.067585/-117.262207

RF5

N El Camino Real & Leucadia Blvd Encinitas, California	1.00 mi radius		3.00 mi radius		5.00 mi radius	
Household Income Distribution						
HH Income \$200,000 or More (2006)	415	11.1%	3,201	10.4%	6,054	11.9%
HH Income \$150,000 to \$199,999 (2006)	559	15.0%	2,654	8.6%	4,403	8.6%
HH Income \$100,000 to \$149,999 (2006)	969	26.0%	6,101	19.8%	10,118	19.8%
HH Income \$75,000 to \$99,999 (2006)	489	13.1%	4,205	13.7%	6,705	13.2%
HH Income \$50,000 to \$74,999 (2006)	478	12.8%	5,288	17.2%	8,403	16.5%
HH Income \$35,000 to \$49,999 (2006)	280	7.5%	3,369	11.0%	5,427	10.6%
HH Income \$25,000 to \$34,999 (2006)	153	4.1%	2,138	7.0%	3,654	7.2%
HH Income \$15,000 to \$24,999 (2006)	197	5.3%	2,089	6.8%	3,403	6.7%
HH Income \$0 to \$14,999 (2006)	186	5.0%	1,711	5.6%	2,815	5.5%
HH Income \$35,000+ (2006)	3,189	85.6%	24,818	80.7%	41,110	80.6%
HH Income \$75,000+ (2006)	2,431	65.3%	16,161	52.5%	27,280	53.5%
Housing						
Total Housing Units (2006)	3,958		33,317		55,813	
Housing Units, Occupied (2006)	3,725	94.1%	30,756	92.3%	50,982	91.3%
<i>Housing Units, Owner-Occupied (2006)</i>	2,992	80.3%	21,987	71.5%	37,211	73.0%
<i>Housing Units, Renter-Occupied (2006)</i>	733	19.7%	8,770	28.5%	13,771	27.0%
Housing Units, Vacant (2006)	232	5.9%	2,560	7.7%	4,831	8.7%
Median Years in Residence (2006)	3.6	yrs	3.6	yrs	3.6	yrs
Marital Status						
Never Married (2006)	1,527	19.0%	15,907	24.9%	24,156	23.4%
Now Married (2006)	5,144	64.1%	35,042	54.9%	58,078	56.2%
Separated (2006)	318	4.0%	3,005	4.7%	4,276	4.1%
Widowed (2006)	305	3.8%	2,656	4.2%	4,907	4.7%
Divorced (2006)	730	9.1%	7,180	11.3%	11,944	11.6%
Household Type						
Population Family (2006)	9,504	89.7%	65,847	82.4%	106,922	82.8%
Population Non-Family (2006)	983	9.3%	13,372	16.7%	21,328	16.5%
Population Group Qtrs (2006)	110	1.0%	712	0.9%	860	0.7%
Family Households (2006)	2,768	74.3%	19,902	64.7%	33,125	65.0%
Married Couple With Children (2006)	1,241	24.1%	7,179	20.5%	11,467	19.7%
Average Family Household Size (2006)	3.43		3.31		3.23	
Non-Family Households (2006)	957	25.7%	10,854	35.3%	17,857	35.0%
Household Size						
1 Person Household (2006)	671	18.0%	7,251	23.6%	12,095	23.7%
2 Person Households (2006)	1,163	31.2%	11,013	35.8%	19,181	37.6%
3 Person Households (2006)	678	18.2%	5,139	16.7%	8,294	16.3%
4 Person Households (2006)	835	22.4%	4,672	15.2%	7,379	14.5%
5 Person Households (2006)	289	7.7%	1,736	5.6%	2,716	5.3%
6+ Person Households (2006)	89	2.4%	946	3.1%	1,317	2.6%
Household Vehicles						
Total Vehicles Available (2006)	8,147		64,820		106,565	
Household: 0 Vehicles Available (2006)	111	3.0%	910	3.0%	1,496	2.9%
Household: 1 Vehicles Available (2006)	787	21.1%	8,155	26.5%	13,890	27.2%
Household: 2+ Vehicles Available (2006)	2,827	75.9%	21,692	70.5%	35,596	69.8%
Average Vehicles Per Household (2006)	2.2		2.1		2.1	

This report was produced using data from private and government sources deemed to be reliable. The information herein is provided without representation or warranty.

DEMOGRAPHIC PROFILE EXPANDED

1990 - 2000 Census, 2006 Estimates & 2011 Projections

Calculated using Proportional Block Groups



Lat/Lon: 33.067585/-117.262207

RF5

N El Camino Real & Leucadia Blvd Encinitas, California	1.00 mi radius		3.00 mi radius		5.00 mi radius	
Labor Force						
Est. Labor: Population Age 16+ (2006)	7,842		62,634		101,629	
Est. Civilian Employed (2006)	5,243	66.9%	42,372	67.7%	66,682	65.6%
Est. Civilian Unemployed (2006)	47	0.6%	1,091	1.7%	1,592	1.6%
Est. in Armed Forces (2006)	35	0.4%	238	0.4%	533	0.5%
Est. not in Labor Force (2006)	2,517	32.1%	18,932	30.2%	32,822	32.3%
Occupation						
Occupation: Population Age 16+ (2000)	4,363		38,767		58,692	
Mgmt, Business, & Financial Operations (2000)	1,107	25.4%	8,578	22.1%	13,932	23.7%
Professional and Related (2000)	1,480	33.9%	11,215	28.9%	16,932	28.8%
Service (2000)	307	7.0%	4,808	12.4%	6,715	11.4%
Sales and Office (2000)	1,181	27.1%	10,053	25.9%	15,377	26.2%
Farming, Fishing, and Forestry (2000)	12	0.3%	117	0.3%	141	0.2%
Construct, Extraction, & Maintenance (2000)	130	3.0%	2,233	5.8%	3,096	5.3%
Production, Transp. & Material Moving (2000)	146	3.4%	1,762	4.5%	2,500	4.3%
Percent White Collar Workers (2000)	86.3%		77.0%		78.8%	
Percent Blue Collar Workers (2000)	13.7%		23.0%		21.2%	
Consumer Expenditure (in \$,000,000s)						
Total Household Expenditure (2006)	\$284		\$2,249		\$3,916	
Total Non-Retail Expenditures (2006)	\$160	56.5%	\$1,267	56.3%	\$2,207	56.3%
Total Retail Expenditures (2006)	\$124	43.5%	\$982	43.7%	\$1,710	43.7%
Apparel (2006)	\$4	1.5%	\$33	1.5%	\$58	1.5%
Contributions (2006)	\$13	4.6%	\$99	4.4%	\$177	4.5%
Education (2006)	\$9	3.0%	\$64	2.8%	\$113	2.9%
Entertainment (2006)	\$17	5.9%	\$132	5.9%	\$230	5.9%
Food And Beverages (2006)	\$43	15.1%	\$344	15.3%	\$596	15.2%
Furnishings And Equipment (2006)	\$14	4.8%	\$106	4.7%	\$186	4.7%
Gifts (2006)	\$9	3.1%	\$68	3.0%	\$121	3.1%
Health Care (2006)	\$16	5.7%	\$133	5.9%	\$231	5.9%
Household Operations (2006)	\$12	4.2%	\$91	4.0%	\$160	4.1%
Miscellaneous Expenses (2006)	\$5	1.6%	\$37	1.7%	\$65	1.7%
Personal Care (2006)	\$4	1.5%	\$33	1.5%	\$58	1.5%
Personal Insurance (2006)	\$3	1.2%	\$26	1.2%	\$47	1.2%
Reading (2006)	\$1	0.3%	\$8	0.3%	\$13	0.3%
Shelter (2006)	\$58	20.4%	\$455	20.2%	\$794	20.3%
Tobacco (2006)	\$1	0.5%	\$13	0.6%	\$22	0.6%
Transportation (2006)	\$56	19.9%	\$453	20.2%	\$784	20.0%
Utilities (2006)	\$19	6.6%	\$152	6.8%	\$263	6.7%
Educational Attainment						
Adult Population (25 Years or Older) (2006)	6,990		55,742		91,405	
Elementary (0 to 8) (2006)	118	1.7%	1,824	3.3%	2,503	2.7%
Some High School (9 to 11) (2006)	164	2.3%	1,747	3.1%	2,838	3.1%
High School Graduate (12) (2006)	601	8.6%	7,284	13.1%	11,732	12.8%
Some College (13 to 16) (2006)	1,328	19.0%	11,279	20.2%	18,489	20.2%
Associate Degree Only (2006)	456	6.5%	3,446	6.2%	5,751	6.3%
Bachelor Degree Only (2006)	2,388	34.2%	17,526	31.4%	28,897	31.6%
Graduate Degree (2006)	1,935	27.7%	12,636	22.7%	21,194	23.2%

This report was produced using data from private and government sources deemed to be reliable. The information herein is provided without representation or warranty.

DEMOGRAPHIC PROFILE EXPANDED

1990 - 2000 Census, 2006 Estimates & 2011 Projections

Calculated using Proportional Block Groups



Lat/Lon: 33.067585/-117.262207

RF5

N El Camino Real & Leucadia Blvd Encinitas, California		1.00 mi radius		3.00 mi radius		5.00 mi radius	
Units In Structure							
1 Detached Unit (2000)	2,452	75.0%	17,639	58.2%	28,310	58.0%	
1 Attached Unit (2000)	211	6.5%	5,409	17.9%	8,911	18.3%	
2 to 4 Units (2000)	56	1.7%	2,172	7.2%	3,354	6.9%	
5 to 9 Units (2000)	127	3.9%	1,499	4.9%	2,351	4.8%	
10 to 19 Units (2000)	44	1.3%	1,133	3.7%	1,607	3.3%	
20 to 49 Units (2000)	48	1.5%	847	2.8%	1,149	2.4%	
50 or more Units (2000)	176	5.4%	837	2.8%	1,592	3.3%	
Mobile Home or Trailer (2000)	151	4.6%	700	2.3%	1,439	2.9%	
Other Structure (2000)	3	0.1%	63	0.2%	63	0.1%	
Homes Built By Year							
Homes Built 1999 to 2000	386	11.8%	1,135	3.7%	2,783	5.7%	
Homes Built 1995 to 1998	274	8.4%	2,232	7.4%	4,334	8.9%	
Homes Built 1990 to 1994	238	7.3%	2,059	6.8%	3,454	7.1%	
Homes Built 1980 to 1989	1,406	43.0%	8,471	28.0%	13,846	28.4%	
Homes Built 1970 to 1979	849	26.0%	10,645	35.1%	15,506	31.8%	
Homes Built 1960 to 1969	63	1.9%	2,668	8.8%	4,050	8.3%	
Homes Built 1950 to 1959	37	1.1%	1,829	6.0%	2,976	6.1%	
Homes Built Before 1949	17	0.5%	1,262	4.2%	1,826	3.7%	
Home Values							
Home Values \$1,000,000 or More (2000)	27	1.2%	415	2.4%	1,431	5.1%	
Home Values \$500,000 to \$999,999 (2000)	272	11.7%	2,853	16.5%	5,386	19.1%	
Home Values \$400,000 to \$499,999 (2000)	482	20.7%	2,485	14.3%	4,171	14.8%	
Home Values \$300,000 to \$399,999 (2000)	1,115	47.9%	5,648	32.6%	7,556	26.8%	
Home Values \$200,000 to \$299,999 (2000)	362	15.6%	4,101	23.7%	6,685	23.8%	
Home Values \$150,000 to \$199,999 (2000)	34	1.5%	1,224	7.1%	2,019	7.2%	
Home Values \$100,000 to \$149,999 (2000)	16	0.7%	494	2.9%	708	2.5%	
Home Values \$70,000 to \$99,999 (2000)	9	0.4%	49	0.3%	95	0.3%	
Home Values \$50,000 to \$69,999 (2000)	0		20	0.1%	33	0.1%	
Home Values \$25,000 to \$49,999 (2000)	10	0.4%	31	0.2%	52	0.2%	
Home Values \$0 to \$24,999 (2000)	0		1	0.0%	6	0.0%	
Owner Occupied Median Home Value (2000)	\$375,420		\$367,367		\$410,962		
Renter Occupied Median Rent (2000)	\$1,046		\$946		\$974		
Transportation To Work							
Drive to Work Alone (2000)	3,509	79.9%	29,947	76.9%	45,837	77.5%	
Drive to Work in Carpool (2000)	240	5.5%	3,308	8.5%	4,606	7.8%	
Travel to Work - Public Transportation (2000)	101	2.3%	1,045	2.7%	1,443	2.4%	
Drive to Work on Motorcycle (2000)	9	0.2%	89	0.2%	136	0.2%	
Walk or Bicycle to Work (2000)	43	1.0%	807	2.1%	1,215	2.1%	
Other Means (2000)	14	0.3%	311	0.8%	521	0.9%	
Work at Home (2000)	475	10.8%	3,457	8.9%	5,358	9.1%	
Travel Time							
Travel to Work in 14 Minutes or Less (2000)	846	21.6%	8,134	22.9%	13,023	24.2%	
Travel to Work in 14 to 29 Minutes (2000)	1,319	33.7%	12,181	34.3%	18,164	33.8%	
Travel to Work in 30 to 59 Minutes (2000)	1,443	36.8%	12,538	35.3%	18,497	34.4%	
Travel to Work in 60 Minutes or More (2000)	309	7.9%	2,654	7.5%	4,074	7.6%	
Average Travel Time to Work (2000)	25.3	mins	25.4	mins	25.1	mins	

This report was produced using data from private and government sources deemed to be reliable. The information herein is provided without representation or warranty.

POSTALCOUNT PRO
DELIVERY STATISTICS as of 11/06
 Calculated using Proportional Postal Carrier Routes



Lat/Lon: 33.067585/-117.262207

Z8

N El Camino Real & Leucadia Blvd Encinitas, California		1.00 mi radius	3.00 mi radius	5.00 mi radius
Summary Data				
Demographic Adjustment	Census 2000 Households	3,165	28,721	45,865
	Route Active Residential Count	5,819	36,650	64,828
	Census 2000 Average Persons per Household	2.80	2.56	2.49
	Census 2000 Population	8,962	74,035	114,991
	Recalculated Route <i>Lower range</i>	16,307	93,706	161,510
	Active Population <i>Upper range</i>	16,479	94,472	162,536
	Census Households vs Route Residential Count	+83.87%	+27.60%	+41.35%
Origination Data				
Residential Demographics	Active Residential Delivery (cr)	3,971	34,160	56,753
	Active Residential Box (cr)	1,848	2,490	8,075
	Active Residential Count (Carrier Route)	5,819	36,650	64,828
	Additional Residential Delivery (zc)	0	0	0
	Additional Residential Box (zc)	0	0	0
	Additional Active Residential Count (Zip Code)	0	0	0
	Additional Active General Delivery Count	0	0	0
	Total Active Residential Count	5,819	36,650	64,828
	Possible Residential Count (Carrier Route)	6,080	37,341	66,198
	Add'l Possible Residential Count (Zip Code)	0	0	0
	Additional Possible General Delivery Count	0	0	0
	Total Possible Residential Count	6,080	37,341	66,198
	Census 2000 Households	3,165	28,721	45,865
	Population in households	8,869	73,434	114,265
	1-person household	17.38%	23.82%	24.30%
	2-person household	31.32%	35.72%	37.45%
	3-person household	18.45%	16.77%	16.18%
	4-person household	22.78%	15.11%	14.28%
	5-person household	7.74%	5.54%	5.21%
	6-or-more person household	2.33%	3.04%	2.58%
	Population in Group Quarters	93	600	726
	Census 2000 Median Age	37.0	37.7	38.9
	Census 2000 Average Household Income	\$105,479	\$90,245	\$97,137
	Census 2000 Median Household Income	\$87,731	\$72,628	\$76,108
	Census 2000 Per Capita Income	\$37,273	\$35,089	\$38,729
	Total Housing Units	3,270	30,300	48,776
	Occupied housing units	96.77%	94.79%	94.03%
Owner-occupied housing units	79.83%	69.80%	71.24%	
Renter-occupied housing units	20.17%	30.20%	28.76%	
Business Demos	Drop Site Business or Family Served Count	0	0	162
	Active Business Deliveries (Carrier Route)	1,352	3,590	6,527
	Additional Active Business Deliveries (Zip Code)	0	8	11
	Total Active Business Deliveries	1,352	3,598	6,538
	Possible Business Deliveries (Carrier Route)	1,411	3,743	6,843
	Add'l Possible Business Deliveries (Zip Code)	0	9	13
	Total Possible Business Deliveries	1,411	3,752	6,856

This report was produced using data from private and government sources deemed to be reliable. The information herein is provided without representation or warranty.

POSTALCOUNT PRO

DELIVERY STATISTICS as of 11/06

Calculated using Proportional Postal Carrier Routes



Lat/Lon: 33.067585/-117.262207

Z8

N El Camino Real & Leucadia Blvd Encinitas, California		1.00 mi radius	3.00 mi radius	5.00 mi radius
SCHEME ACTIVE POSTAL DROP	BUSINESS	Scheme Active Business Count		
		1,352	3,598	6,538
		18	337	764
		8	82	115
		217	845	1,502
		54	847	1,456
		1,055	1,479	2,483
		0	0	0
		0	0	208
		0	0	0
		0	8	11
		Scheme Active Residential Count		
		5,819	36,650	64,828
		593	4,151	7,011
		1,194	11,928	18,023
		1,290	11,245	22,741
		894	6,835	8,979
		1,848	2,490	6,990
		0	0	0
	0	0	1,085	
	0	0	0	
	0	0	0	
	0	0	0	
	0	0	0	
	Scheme Possible Business Count			
	1,411	3,752	6,856	
	20	347	806	
	8	89	124	
	221	900	1,637	
	56	875	1,517	
	1,106	1,532	2,546	
	0	0	0	
	0	0	213	
	0	0	0	
	0	9	13	
	Scheme Possible Residential Count			
	6,080	37,341	66,198	
	599	4,195	7,070	
	1,205	12,080	18,267	
	1,293	11,389	22,976	
	898	6,942	9,117	
	2,085	2,734	7,302	
	0	0	0	
	0	0	1,466	
	0	0	0	
	0	0	0	
	0	0	0	
	0	0	0	
	Scheme Drop			
	Scheme Drop Business Family Served Count			
	0	0	162	
	Scheme Active Business: Residential Mix			
	0	0	0	
	Scheme Active Residential: Business Mix			
	0	0	0	
	Facility Locations			
	0	2	3	

This report was produced using data from private and government sources deemed to be reliable. The information herein is provided without representation or warranty.

Percentage of count derived from Carrier Route Geography^[1] 100.0% 100.0% 100.0%

Percentage of count derived from Zip Code Geography^[2] 0.0% 0.0% 0.0%

2000 Census Block Group Data and Geography, (SF3 release for Income, SF1 release for remainder, Average Income = Aggregate Income / Households).

^[1] Delivery statistics are determined using Carrier Route Geography from GDT; if this level of geography is not available (usually in rural locations), ^[2] Zip Code Geography is used.