



# RETAIL CENTER FOR LEASE

## NWC Mesa College Dr & Ashford St San Diego, California



CLOSE TO



### FEATURES

- Positioned on main entry to San Diego Mesa College and Kearny High School
- 27,268 students, 600 faculty and staff at Mesa College
- 2,000 students, 200 faculty and staff at Kearny High School
- Convenient to major medical facilities including Sharp Rees-Stealy & Rady Children's Hospital, with approximately 35,000 daily visits.

### DEMOGRAPHICS

	1 Mile	3 Mile	5 Mile
2006 Population:	22,719	136,454	387,700
2011 Proj Population:	23,530	142,569	399,169
Avg HH Income:	\$55,435	\$64,679	\$65,324
Daytime Population:	27,374	159,899	281,880

### TRAFFIC COUNTS

(SANDAG 2006)

Mesa College Drive	23,200 ADT
Ashford Street	5,100 ADT

**GREG SPOUNIAS**

Lic.# 01200692

858.523.2093

gspounias@retailinsite.net

**RYAN ROGERS**

Lic.# 01249230

858.523.2098

rrogers@retailinsite.net

**RETAIL INSITE**

12264 EL CAMINO REAL STE. 202 SAN DIEGO, CA 92130  
LIC # 01206760 | F: 858 523 2095 | RETAILINSITE.NET

A MEMBER OF  
**CHAINLINKS**  
RETAIL ADVISORS

The information above has been obtained from sources believed to be reliable. While we do not doubt its accuracy, we have not verified it and make no guarantee, warranty or representation about it. It is your responsibility to independently confirm its accuracy and completeness. Any projections, opinions, assumptions or estimates used are for example only and do not represent the current or future performance of the property. The value of this transaction to you depends on tax and other factors which should be evaluated by your tax, financial and legal advisors. You and your advisors should conduct a careful, independent investigation of the property to determine to your satisfaction the suitability of the property for your needs.



# RETAIL CENTER FOR LEASE

## NWC Mesa College Dr & Ashford St San Diego, California

AERIAL



**GREG SPOUNIAS**  
Lic.# 01200692  
858.523.2093  
gspounias@retailinsite.net

**RYAN ROGERS**  
Lic.# 01249230  
858.523.2098  
rrogers@retailinsite.net

**RETAIL INSITE**

12264 EL CAMINO REAL STE. 202 SAN DIEGO, CA 92130  
LIC # 01206760 | F: 858 523 2095 | RETAILINSITE.NET

A MEMBER OF  
**CHAINLINKS**  
RETAIL ADVISORS

The information above has been obtained from sources believed to be reliable. While we do not doubt its accuracy, we have not verified it and make no guarantee, warranty or representation about it. It is your responsibility to independently confirm its accuracy and completeness. Any projections, opinions, assumptions or estimates used are for example only and do not represent the current or future performance of the property. The value of this transaction to you depends on tax and other factors which should be evaluated by your tax, financial and legal advisors. You and your advisors should conduct a careful, independent investigation of the property to determine to your satisfaction the suitability of the property for your needs.



# RETAIL CENTER FOR LEASE

## NWC Mesa College Dr & Ashford St San Diego, California

### SITE PLAN

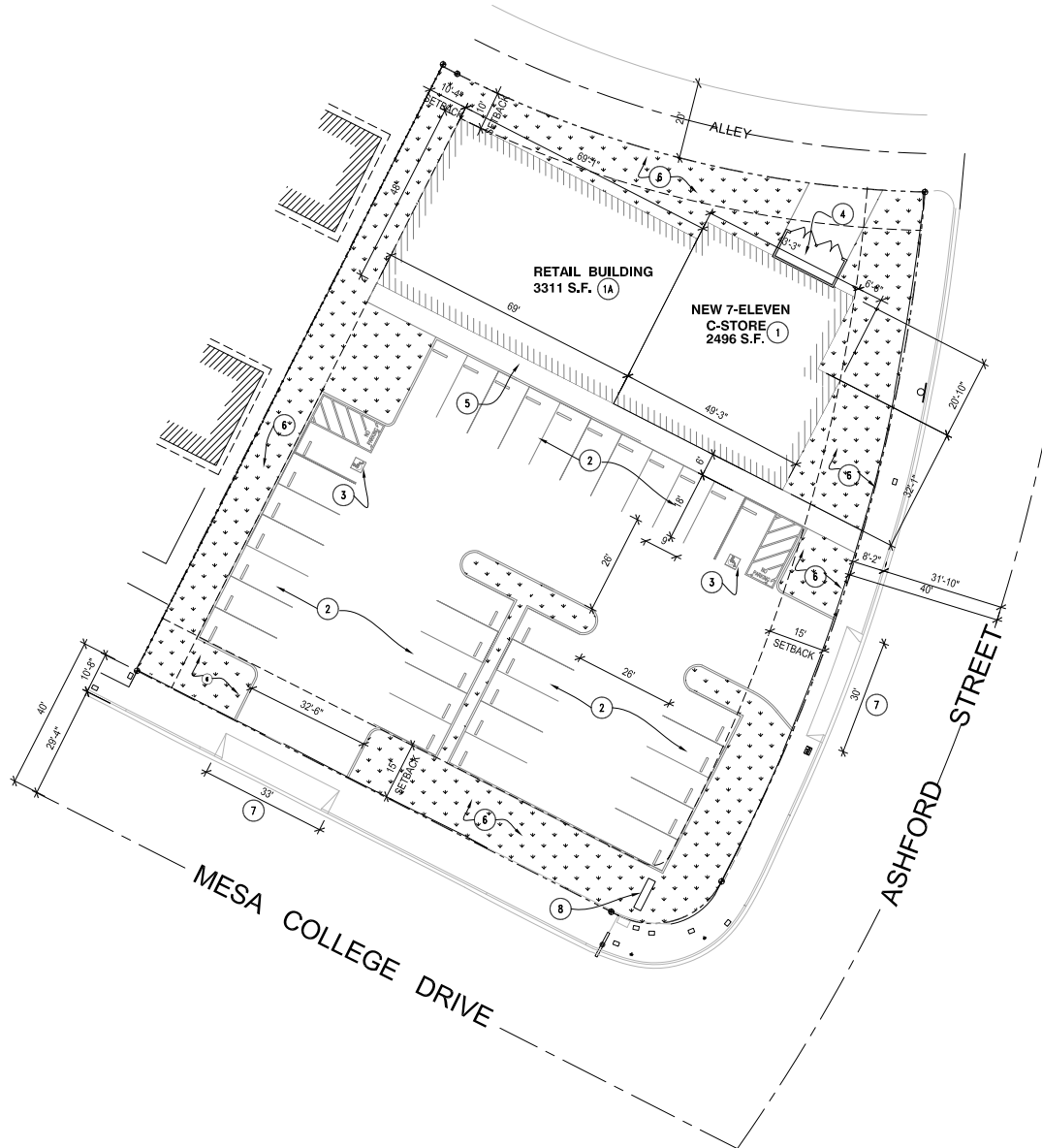

**1 PRELIMINARY SITE PLAN**  
SP-1 SCALE: 1"= 20'-0"

**GREG SPOUNIAS**  
Lic.# 01200692  
858.523.2093  
gspounias@retailinsite.net

**RYAN ROGERS**  
Lic.# 01249230  
858.523.2098  
rrogers@retailinsite.net

# RETAIL INSITE

12264 EL CAMINO REAL STE. 202 SAN DIEGO, CA 92130  
LIC # 01206760 | F: 858 523 2095 | RETAILINSITE.NET

A MEMBER OF  
**CHAINLINKS**  
RETAIL ADVISORS

The information above has been obtained from sources believed to be reliable. While we do not doubt its accuracy, we have not verified it and make no guarantee, warranty or representation about it. It is your responsibility to independently confirm its accuracy and completeness. Any projections, opinions, assumptions or estimates used are for example only and do not represent the current or future performance of the property. The value of this transaction to you depends on tax and other factors which should be evaluated by your tax, financial and legal advisors. You and your advisors should conduct a careful, independent investigation of the property to determine to your satisfaction the suitability of the property for your needs.

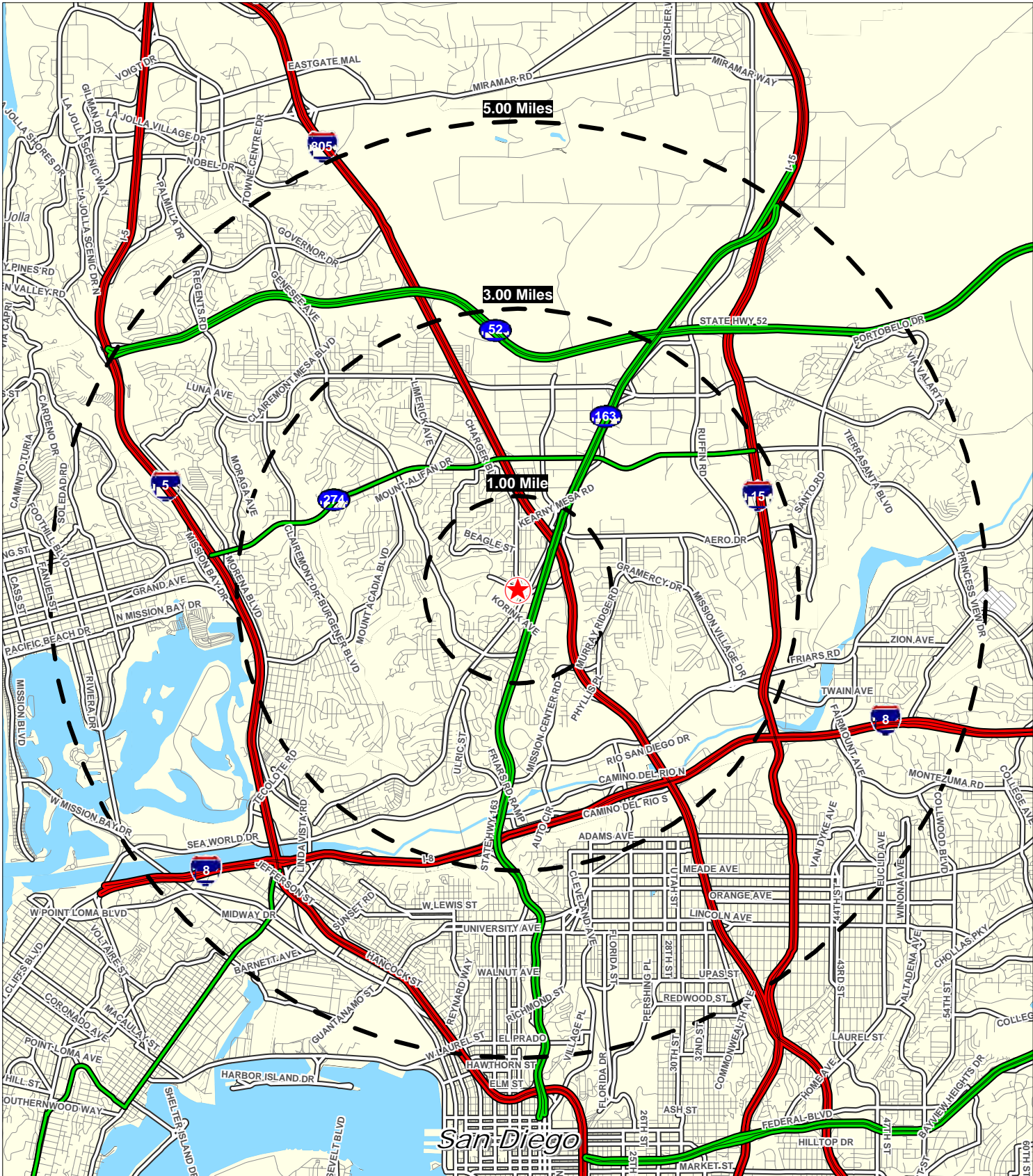

**Mesa College Dr & Ashford St**  
**San Diego, California**

# DEMOGRAPHIC PROFILE EXPANDED

1990 - 2000 Census, 2006 Estimates & 2011 Projections

Calculated using Proportional Block Groups



Lat/Lon: 32.80143/-117.159622

RF5

Mesa College Dr & Ashford St San Diego, California	1.00 mi radius		3.00 mi radius		5.00 mi radius	
<b>Population</b>						
Estimated Population (2006)	22,719		136,454		387,700	
Census Population (1990)	21,578		122,628		353,811	
Census Population (2000)	21,757		129,032		374,097	
Projected Population (2011)	23,530		142,569		399,169	
Forecasted Population (2016)	24,483		151,786		418,209	
Historical Annual Growth (1990 to 2000)	178	0.1%	6,404	0.5%	20,287	0.6%
Historical Annual Growth (2000 to 2006)	963	0.7%	7,422	1.0%	13,603	0.6%
Projected Annual Growth (2006 to 2011)	811	0.7%	6,115	0.9%	11,469	0.6%
Est. Population Density (2006)	7,235.37 <i>psm</i>		4,831.43 <i>psm</i>		5,077.80 <i>psm</i>	
Trade Area Size	3.14 <i>sq mi</i>		28.24 <i>sq mi</i>		76.35 <i>sq mi</i>	
<b>Households</b>						
Estimated Households (2006)	7,750		54,243		165,537	
Census Households (1990)	7,374		47,214		150,782	
Census Households (2000)	7,479		51,263		160,763	
Projected Households (2011)	8,007		56,844		170,074	
Forecasted Households (2016)	7,875		56,955		167,134	
Households with Children (2006)	2,668	34.4%	13,783	25.4%	37,418	22.6%
Average Household Size (2006)	2.76		2.45		2.26	
<b>Average Household Income</b>						
Est. Average Household Income (2006)	\$51,608		\$59,646		\$60,557	
Proj. Average Household Income (2011)	\$55,435		\$64,679		\$65,324	
Average Family Income (2006)	\$53,212		\$64,137		\$70,243	
<b>Median Household Income</b>						
Est. Median Household Income (2006)	\$46,830		\$53,178		\$50,249	
Proj. Median Household Income (2011)	\$50,334		\$58,008		\$54,564	
Median Family Income (2006)	\$51,289		\$59,479		\$60,440	
<b>Per Capita Income</b>						
Est. Per Capita Income (2006)	\$18,744		\$24,158		\$26,775	
Proj. Per Capita Income (2011)	\$20,196		\$26,308		\$28,914	
Per Capita Income Est. 5 year change	\$1,451	7.7%	\$2,150	8.9%	\$2,139	8.0%
<b>Other Income</b>						
Est. Median Disposable Income (2006)	\$39,737		\$44,653		\$42,299	
Est. Median Disposable Income (2011)	\$42,318		\$48,153		\$45,475	
Disposable Income Est. 5 year change	\$2,581	6.5%	\$3,500	7.8%	\$3,177	7.5%
Est. Median Household Net Worth (2006)	\$35,637		\$39,504		\$36,998	
<b>Daytime Demos</b>						
Total Number of Businesses (2006)	794		10,198		22,607	
Total Number of Employees (2006)	27,374		159,899		281,880	
Company Headqtrs: Businesses (2006)	2	0.2%	58	0.6%	79	0.3%
Company Headqtrs: Employees (2006)	209	0.8%	7,856	4.9%	10,319	3.7%
Unemployment Rate (2006)	2.40%		2.20%		2.30%	
Employee Population per Business	34.5 to 1		15.7 to 1		12.5 to 1	
Residential Population per Business	28.6 to 1		13.4 to 1		17.1 to 1	

This report was produced using data from private and government sources deemed to be reliable. The information herein is provided without representation or warranty.

# DEMOGRAPHIC PROFILE EXPANDED

1990 - 2000 Census, 2006 Estimates & 2011 Projections

Calculated using Proportional Block Groups



Lat/Lon: 32.80143/-117.159622

.RF5

## Mesa College Dr & Ashford St San Diego, California

	1.00 mi radius		3.00 mi radius		5.00 mi radius	
<b>Race &amp; Ethnicity</b>						
White (2006)	13,853	61.0%	96,532	70.7%	282,214	72.8%
Black or African American (2006)	1,875	8.3%	6,636	4.9%	21,331	5.5%
American Indian & Alaska Native (2006)	124	0.5%	615	0.5%	1,796	0.5%
Asian (2006)	4,119	18.1%	19,156	14.0%	39,864	10.3%
Hawaiian & Pacific Islander (2006)	153	0.7%	867	0.6%	1,865	0.5%
Other Race (2006)	1,485	6.5%	7,259	5.3%	26,389	6.8%
Two or More Races (2006)	1,111	4.9%	5,390	4.0%	14,240	3.7%
Not Hispanic or Latino Population (2006)	17,474	76.9%	107,587	78.8%	294,858	76.1%
Hispanic or Latino Population (2006)	5,245	23.1%	28,866	21.2%	92,842	23.9%
Not of Hispanic Origin Population (1990)	18,768	87.0%	107,223	87.4%	304,768	86.1%
Hispanic Origin Population (1990)	2,811	13.0%	15,405	12.6%	49,043	13.9%
Not Hispanic or Latino Population (2000)	17,607	80.9%	106,725	82.7%	298,962	79.9%
Hispanic or Latino Population (2000)	4,150	19.1%	22,307	17.3%	75,135	20.1%
Not Hispanic or Latino Population (2011)	17,452	74.2%	108,568	76.2%	293,113	73.4%
Hispanic or Latino Population (2011)	6,078	25.8%	34,000	23.8%	106,055	26.6%
Hist. Hispanic Ann Growth (1990 to 2006)	2,435	5.4%	13,461	5.5%	43,799	5.6%
Proj. Hispanic Ann Growth (2006 to 2011)	833	3.2%	5,134	3.6%	13,214	2.8%
<b>Age Distribution</b>						
Age 0 to 4 yrs (2006)	2,033	8.9%	9,284	6.8%	25,214	6.5%
Age 5 to 9 yrs (2006)	1,669	7.3%	8,160	6.0%	22,041	5.7%
Age 10 to 14 yrs (2006)	1,519	6.7%	7,681	5.6%	20,276	5.2%
Age 15 to 19 yrs (2006)	1,702	7.5%	8,363	6.1%	22,071	5.7%
Age 20 to 24 yrs (2006)	1,891	8.3%	10,614	7.8%	31,861	8.2%
Age 25 to 29 yrs (2006)	1,993	8.8%	12,259	9.0%	38,340	9.9%
Age 30 to 34 yrs (2006)	1,877	8.3%	11,870	8.7%	35,750	9.2%
Age 35 to 39 yrs (2006)	1,741	7.7%	10,725	7.9%	31,060	8.0%
Age 40 to 44 yrs (2006)	1,467	6.5%	9,902	7.3%	28,245	7.3%
Age 45 to 49 yrs (2006)	1,247	5.5%	9,286	6.8%	26,695	6.9%
Age 50 to 54 yrs (2006)	1,097	4.8%	8,380	6.1%	24,513	6.3%
Age 55 to 59 yrs (2006)	938	4.1%	6,975	5.1%	20,271	5.2%
Age 60 to 64 yrs (2006)	849	3.7%	5,856	4.3%	15,418	4.0%
Age 65 to 74 yrs (2006)	1,297	5.7%	8,851	6.5%	22,266	5.7%
Age 75 to 84 yrs (2006)	950	4.2%	6,036	4.4%	16,250	4.2%
Age 85 yrs plus (2006)	447	2.0%	2,213	1.6%	7,430	1.9%
Median Age (2006)	31.8	yrs	34.6	yrs	34.7	yrs
<b>Gender Age Distribution</b>						
Female Population (2006)	11,333	49.9%	68,994	50.6%	191,319	49.3%
Age 0 to 19 yrs (2006)	3,275	28.9%	16,452	23.8%	42,973	22.5%
Age 20 to 64 yrs (2006)	6,407	56.5%	42,529	61.6%	121,424	63.5%
Age 65 yrs plus (2006)	1,652	14.6%	10,012	14.5%	26,922	14.1%
Female Median Age (2006)	33.8	yrs	35.9	yrs	36.0	yrs
Male Population (2006)	11,386	50.1%	67,460	49.4%	196,381	50.7%
Age 0 to 19 yrs (2006)	3,648	32.0%	17,036	25.3%	46,629	23.7%
Age 20 to 64 yrs (2006)	6,695	58.8%	43,338	64.2%	130,729	66.6%
Age 65 yrs plus (2006)	1,043	9.2%	7,087	10.5%	19,023	9.7%
Male Median Age (2006)	30.2	yrs	33.4	yrs	33.6	yrs

This report was produced using data from private and government sources deemed to be reliable. The information herein is provided without representation or warranty.

# DEMOGRAPHIC PROFILE EXPANDED

1990 - 2000 Census, 2006 Estimates & 2011 Projections

Calculated using Proportional Block Groups



Lat/Lon: 32.80143/-117.159622

.RF5

Mesa College Dr & Ashford St San Diego, California	1.00 mi radius		3.00 mi radius		5.00 mi radius	
<b>Household Income Distribution</b>						
HH Income \$200,000 or More (2006)	63	0.8%	1,072	2.0%	5,010	3.0%
HH Income \$150,000 to \$199,999 (2006)	148	1.9%	1,529	2.8%	4,771	2.9%
HH Income \$100,000 to \$149,999 (2006)	720	9.3%	6,379	11.8%	17,181	10.4%
HH Income \$75,000 to \$99,999 (2006)	907	11.7%	7,156	13.2%	18,241	11.0%
HH Income \$50,000 to \$74,999 (2006)	1,726	22.3%	11,713	21.6%	32,272	19.5%
HH Income \$35,000 to \$49,999 (2006)	1,333	17.2%	8,795	16.2%	26,282	15.9%
HH Income \$25,000 to \$34,999 (2006)	1,019	13.1%	6,517	12.0%	20,725	12.5%
HH Income \$15,000 to \$24,999 (2006)	786	10.1%	5,302	9.8%	19,164	11.6%
HH Income \$0 to \$14,999 (2006)	1,047	13.5%	5,779	10.7%	21,892	13.2%
HH Income \$35,000+ (2006)	4,898	63.2%	36,645	67.6%	103,757	62.7%
HH Income \$75,000+ (2006)	1,839	23.7%	16,136	29.7%	45,203	27.3%
<b>Housing</b>						
Total Housing Units (2006)	8,084		57,676		176,551	
Housing Units, Occupied (2006)	7,750	95.9%	54,243	94.0%	165,537	93.8%
<i>Housing Units, Owner-Occupied (2006)</i>	3,313	42.7%	28,082	51.8%	72,513	43.8%
<i>Housing Units, Renter-Occupied (2006)</i>	4,437	57.3%	26,160	48.2%	93,024	56.2%
Housing Units, Vacant (2006)	334	4.1%	3,434	6.0%	11,013	6.2%
Median Years in Residence (2006)	3.4	<i>yrs</i>	3.7	<i>yrs</i>	3.2	<i>yrs</i>
<b>Marital Status</b>						
Never Married (2006)	5,235	29.9%	36,639	32.9%	121,485	37.9%
Now Married (2006)	8,180	46.7%	49,487	44.4%	126,092	39.4%
Separated (2006)	1,118	6.4%	5,781	5.2%	16,571	5.2%
Widowed (2006)	889	5.1%	6,304	5.7%	16,780	5.2%
Divorced (2006)	2,077	11.9%	13,121	11.8%	39,242	12.3%
<b>Household Type</b>						
Population Family (2006)	17,632	77.6%	101,285	74.2%	262,431	67.7%
Population Non-Family (2006)	3,795	16.7%	31,533	23.1%	112,399	29.0%
Population Group Qtrs (2006)	1,292	5.7%	3,635	2.7%	12,871	3.3%
Family Households (2006)	4,819	62.2%	30,103	55.5%	79,640	48.1%
Married Couple With Children (2006)	1,803	22.0%	8,852	17.9%	22,544	17.9%
Average Family Household Size (2006)	3.66		3.36		3.30	
Non-Family Households (2006)	2,930	37.8%	24,139	44.5%	85,898	51.9%
<b>Household Size</b>						
1 Person Household (2006)	1,967	25.4%	15,712	29.0%	56,535	34.2%
2 Person Households (2006)	2,211	28.5%	19,303	35.6%	58,409	35.3%
3 Person Households (2006)	1,318	17.0%	8,113	15.0%	22,334	13.5%
4 Person Households (2006)	1,215	15.7%	5,916	10.9%	15,364	9.3%
5 Person Households (2006)	575	7.4%	2,942	5.4%	7,632	4.6%
6+ Person Households (2006)	463	6.0%	2,258	4.2%	5,264	3.2%
<b>Household Vehicles</b>						
Total Vehicles Available (2006)	14,001		105,618		299,786	
Household: 0 Vehicles Available (2006)	517	6.7%	2,825	5.2%	11,346	6.9%
Household: 1 Vehicles Available (2006)	2,877	37.1%	19,265	35.5%	65,155	39.4%
Household: 2+ Vehicles Available (2006)	4,355	56.2%	32,152	59.3%	89,036	53.8%
Average Vehicles Per Household (2006)	1.8		1.9		1.8	

This report was produced using data from private and government sources deemed to be reliable. The information herein is provided without representation or warranty.

# DEMOGRAPHIC PROFILE EXPANDED

1990 - 2000 Census, 2006 Estimates & 2011 Projections

Calculated using Proportional Block Groups



Lat/Lon: 32.80143/-117.159622

.RF5

Mesa College Dr & Ashford St San Diego, California	1.00 mi radius		3.00 mi radius		5.00 mi radius	
<b>Labor Force</b>						
Est. Labor: Population Age 16+ (2006)	17,143		109,691		315,832	
Est. Civilian Employed (2006)	9,681	56.5%	67,213	61.3%	196,040	62.1%
Est. Civilian Unemployed (2006)	403	2.4%	2,446	2.2%	7,110	2.3%
Est. in Armed Forces (2006)	967	5.6%	3,376	3.1%	12,465	3.9%
Est. not in Labor Force (2006)	6,092	35.5%	36,656	33.4%	100,217	31.7%
<b>Occupation</b>						
Occupation: Population Age 16+ (2000)	9,018		62,155		186,720	
Mgmt, Business, & Financial Operations (2000)	1,138	12.6%	9,078	14.6%	27,421	14.7%
Professional and Related (2000)	1,925	21.3%	15,929	25.6%	52,143	27.9%
Service (2000)	1,571	17.4%	9,891	15.9%	29,473	15.8%
Sales and Office (2000)	2,608	28.9%	17,733	28.5%	51,152	27.4%
Farming, Fishing, and Forestry (2000)	81	0.9%	130	0.2%	377	0.2%
Construct, Extraction, & Maintenance (2000)	789	8.7%	4,228	6.8%	12,017	6.4%
Production, Transp. & Material Moving (2000)	906	10.0%	5,167	8.3%	14,139	7.6%
Percent White Collar Workers (2000)	62.9%		68.8%		70.0%	
Percent Blue Collar Workers (2000)	37.1%		31.2%		30.0%	
<b>Consumer Expenditure (in \$,000,000s)</b>						
Total Household Expenditure (2006)	\$345		\$2,668		\$8,181	
Total Non-Retail Expenditures (2006)	\$193	56.0%	\$1,494	56.0%	\$4,574	55.9%
Total Retail Expenditures (2006)	\$152	44.0%	\$1,174	44.0%	\$3,607	44.1%
Apparel (2006)	\$5	1.5%	\$39	1.5%	\$119	1.5%
Contributions (2006)	\$12	3.5%	\$98	3.7%	\$308	3.8%
Education (2006)	\$8	2.3%	\$64	2.4%	\$201	2.5%
Entertainment (2006)	\$20	5.7%	\$153	5.8%	\$470	5.7%
Food And Beverages (2006)	\$56	16.2%	\$427	16.0%	\$1,308	16.0%
Furnishings And Equipment (2006)	\$15	4.4%	\$120	4.5%	\$366	4.5%
Gifts (2006)	\$9	2.6%	\$71	2.7%	\$222	2.7%
Health Care (2006)	\$22	6.5%	\$172	6.4%	\$527	6.4%
Household Operations (2006)	\$12	3.5%	\$96	3.6%	\$296	3.6%
Miscellaneous Expenses (2006)	\$6	1.8%	\$47	1.8%	\$143	1.8%
Personal Care (2006)	\$5	1.5%	\$40	1.5%	\$123	1.5%
Personal Insurance (2006)	\$3	1.0%	\$27	1.0%	\$85	1.0%
Reading (2006)	\$1	0.3%	\$9	0.3%	\$28	0.3%
Shelter (2006)	\$68	19.8%	\$530	19.9%	\$1,628	19.9%
Tobacco (2006)	\$3	0.7%	\$19	0.7%	\$57	0.7%
Transportation (2006)	\$73	21.1%	\$559	20.9%	\$1,694	20.7%
Utilities (2006)	\$26	7.5%	\$197	7.4%	\$604	7.4%
<b>Educational Attainment</b>						
Adult Population (25 Years or Older) (2006)	13,905		92,352		266,238	
Elementary (0 to 8) (2006)	925	6.7%	4,320	4.7%	13,034	4.9%
Some High School (9 to 11) (2006)	974	7.0%	6,146	6.7%	16,993	6.4%
High School Graduate (12) (2006)	3,333	24.0%	18,983	20.6%	49,053	18.4%
Some College (13 to 16) (2006)	3,803	27.3%	22,097	23.9%	61,678	23.2%
Associate Degree Only (2006)	1,097	7.9%	7,142	7.7%	19,226	7.2%
Bachelor Degree Only (2006)	2,414	17.4%	21,080	22.8%	63,031	23.7%
Graduate Degree (2006)	1,360	9.8%	12,584	13.6%	43,225	16.2%

This report was produced using data from private and government sources deemed to be reliable. The information herein is provided without representation or warranty.

# DEMOGRAPHIC PROFILE EXPANDED

1990 - 2000 Census, 2006 Estimates & 2011 Projections

Calculated using Proportional Block Groups



Lat/Lon: 32.80143/-117.159622

RF5

Mesa College Dr & Ashford St San Diego, California	1.00 mi radius		3.00 mi radius		5.00 mi radius	
<b>Units In Structure</b>						
1 Detached Unit (2000)	3,238	42.6%	24,117	45.5%	66,031	39.5%
1 Attached Unit (2000)	759	10.0%	5,390	10.2%	13,968	8.4%
2 to 4 Units (2000)	761	10.0%	3,728	7.0%	16,156	9.7%
5 to 9 Units (2000)	656	8.6%	3,657	6.9%	21,513	12.9%
10 to 19 Units (2000)	429	5.6%	3,653	6.9%	16,064	9.6%
20 to 49 Units (2000)	679	8.9%	4,209	7.9%	14,031	8.4%
50 or more Units (2000)	1,022	13.4%	7,546	14.2%	17,151	10.3%
Mobile Home or Trailer (2000)	61	0.8%	710	1.3%	1,828	1.1%
Other Structure (2000)	0		22	0.0%	226	0.1%
<b>Homes Built By Year</b>						
Homes Built 1999 to 2000	1	0.0%	1,585	3.0%	1,969	1.2%
Homes Built 1995 to 1998	119	1.6%	1,804	3.4%	3,084	1.8%
Homes Built 1990 to 1994	158	2.1%	1,586	3.0%	6,328	3.8%
Homes Built 1980 to 1989	1,114	14.6%	6,846	12.9%	22,326	13.4%
Homes Built 1970 to 1979	1,976	26.0%	11,558	21.8%	39,623	23.7%
Homes Built 1960 to 1969	1,590	20.9%	10,812	20.4%	31,568	18.9%
Homes Built 1950 to 1959	2,057	27.1%	13,938	26.3%	32,230	19.3%
Homes Built Before 1949	589	7.7%	4,903	9.2%	29,840	17.9%
<b>Home Values</b>						
Home Values \$1,000,000 or More (2000)	0		53	0.3%	327	0.6%
Home Values \$500,000 to \$999,999 (2000)	4	0.2%	300	1.4%	3,083	5.8%
Home Values \$400,000 to \$499,999 (2000)	7	0.3%	602	2.8%	3,681	7.0%
Home Values \$300,000 to \$399,999 (2000)	25	1.0%	1,941	9.1%	8,362	15.8%
Home Values \$200,000 to \$299,999 (2000)	1,022	40.3%	9,819	46.3%	20,473	38.8%
Home Values \$150,000 to \$199,999 (2000)	1,104	43.6%	6,390	30.1%	11,368	21.5%
Home Values \$100,000 to \$149,999 (2000)	323	12.7%	1,689	8.0%	4,098	7.8%
Home Values \$70,000 to \$99,999 (2000)	31	1.2%	263	1.2%	964	1.8%
Home Values \$50,000 to \$69,999 (2000)	0		23	0.1%	142	0.3%
Home Values \$25,000 to \$49,999 (2000)	0		50	0.2%	140	0.3%
Home Values \$0 to \$24,999 (2000)	20	0.8%	88	0.4%	133	0.3%
Owner Occupied Median Home Value (2000)	\$192,835		\$225,329		\$265,248	
Renter Occupied Median Rent (2000)	\$760		\$835		\$736	
<b>Transportation To Work</b>						
Drive to Work Alone (2000)	7,583	76.0%	51,292	78.5%	149,984	75.5%
Drive to Work in Carpool (2000)	1,206	12.1%	7,141	10.9%	21,570	10.9%
Travel to Work - Public Transportation (2000)	511	5.1%	2,284	3.5%	8,504	4.3%
Drive to Work on Motorcycle (2000)	80	0.8%	281	0.4%	767	0.4%
Walk or Bicycle to Work (2000)	232	2.3%	1,627	2.5%	7,986	4.0%
Other Means (2000)	54	0.5%	346	0.5%	1,621	0.8%
Work at Home (2000)	319	3.2%	2,366	3.6%	8,103	4.1%
<b>Travel Time</b>						
Travel to Work in 14 Minutes or Less (2000)	2,703	28.0%	17,864	28.4%	53,972	28.3%
Travel to Work in 14 to 29 Minutes (2000)	4,858	50.3%	31,858	50.6%	93,430	49.1%
Travel to Work in 30 to 59 Minutes (2000)	1,747	18.1%	10,852	17.2%	35,555	18.7%
Travel to Work in 60 Minutes or More (2000)	357	3.7%	2,397	3.8%	7,474	3.9%
Average Travel Time to Work (2000)	20.2	mins	20.2	mins	20.2	mins

This report was produced using data from private and government sources deemed to be reliable. The information herein is provided without representation or warranty.

**POSTALCOUNT PRO**  
**DELIVERY STATISTICS as of 11/06**  
 Calculated using Proportional Postal Carrier Routes



Lat/Lon: 32.80143/-117.159622

Z8

Mesa College Dr & Ashford St San Diego, California		1.00 mi radius	3.00 mi radius	5.00 mi radius
<b>Summary Data</b>				
<b>Demographic Adjustment</b>	Census 2000 Households	7,479	51,263	160,763
	Route Active Residential Count	8,422	60,207	181,460
	Census 2000 Average Persons per Household	2.76	2.46	2.26
	Census 2000 Population	21,757	129,032	374,097
	Recalculated Route <i>Lower range</i>	23,277	147,953	410,034
	Active Population <i>Upper range</i>	24,501	151,544	422,259
	Census Households vs Route Residential Count	+12.62%	+17.45%	+12.87%
<b>Origination Data</b>				
<b>Residential Demographics</b>	Active Residential Delivery (cr)	7,346	56,229	168,582
	Active Residential Box (cr)	1,076	3,978	12,878
	Active Residential Count (Carrier Route)	8,422	60,207	181,460
	Additional Residential Delivery (zc)	0	0	0
	Additional Residential Box (zc)	0	0	0
	Additional Active Residential Count (Zip Code)	0	0	0
	Additional Active General Delivery Count	0	0	0
	Total Active Residential Count	8,422	60,207	181,460
	Possible Residential Count (Carrier Route)	9,067	61,982	186,292
	Add'l Possible Residential Count (Zip Code)	0	0	0
	Additional Possible General Delivery Count	0	0	0
	Total Possible Residential Count	9,067	61,982	186,292
	Census 2000 Households	7,479	51,263	160,763
	Population in households	20,669	125,974	363,267
	1-person household	25.31%	29.28%	35.21%
	2-person household	28.24%	34.83%	34.38%
	3-person household	17.16%	14.96%	13.36%
	4-person household	15.89%	11.12%	9.29%
	5-person household	7.45%	5.55%	4.59%
	6-or-more person household	5.95%	4.27%	3.18%
	Population in Group Quarters	1,087	3,058	10,830
	Census 2000 Median Age	30.7	33.7	33.7
	Census 2000 Average Household Income	\$49,264	\$55,943	\$54,806
	Census 2000 Median Household Income	\$41,784	\$47,026	\$44,542
	Census 2000 Per Capita Income	\$16,788	\$22,099	\$23,511
Total Housing Units	7,604	53,032	166,969	
Occupied housing units	98.35%	96.66%	96.28%	
Owner-occupied housing units	40.38%	49.94%	41.31%	
Renter-occupied housing units	59.62%	50.06%	58.69%	
<b>Business Demos</b>	Drop Site Business or Family Served Count	1	18	20
	Active Business Deliveries (Carrier Route)	762	5,212	16,106
	Additional Active Business Deliveries (Zip Code)	506	3,285	4,186
	Total Active Business Deliveries	1,268	8,497	20,292
	Possible Business Deliveries (Carrier Route)	791	5,399	16,826
	Add'l Possible Business Deliveries (Zip Code)	525	3,424	4,641
	Total Possible Business Deliveries	1,315	8,823	21,467

This report was produced using data from private and government sources deemed to be reliable. The information herein is provided without representation or warranty.

# POSTALCOUNT PRO

DELIVERY STATISTICS as of 11/06

Calculated using Proportional Postal Carrier Routes



Lat/Lon: 32.80143/-117.159622

Z8

Mesa College Dr & Ashford St San Diego, California		1.00 mi radius	3.00 mi radius	5.00 mi radius
<b>SCHEME ACTIVE POSTAL DROP</b>	<b>BUSINESS</b>	<b>Scheme Active Business Count</b>		
		1,268	8,497	20,292
		158	2,137	3,721
		0	7	27
		161	1,263	1,993
		623	3,802	9,939
		326	1,227	4,302
		0	0	0
		0	0	0
		0	0	0
		0	61	310
		<b>Scheme Active Residential Count</b>		
		8,422	60,207	181,460
		1,986	21,141	74,170
		2	357	945
		1,763	7,820	13,647
		3,595	26,909	79,820
		1,076	3,978	12,878
		0	0	0
	0	0	0	
	0	0	0	
	0	0	0	
	0	0	0	
	0	0	0	
	<b>Scheme Possible Business Count</b>			
	1,315	8,823	21,467	
	165	2,220	3,881	
	0	7	27	
	166	1,296	2,050	
	650	3,942	10,307	
	333	1,283	4,605	
	0	0	0	
	0	0	0	
	0	0	0	
	0	75	597	
	<b>Scheme Possible Residential Count</b>			
	9,067	61,982	186,292	
	1,987	21,196	74,466	
	2	358	950	
	1,765	7,829	13,673	
	3,620	27,136	80,664	
	1,693	5,463	16,538	
	0	0	0	
	0	0	0	
	0	0	0	
	0	0	0	
	0	0	0	
	0	0	0	
	0	0	0	
	<b>Scheme Drop</b>			
	<b>Scheme Drop Business Family Served Count</b>			
	0	10	10	
	<b>Scheme Active Business: Residential Mix</b>			
	0	0	0	
	<b>Scheme Active Residential: Business Mix</b>			
	1	8	10	
	<b>Facility Locations</b>			
	0	3	12	

This report was produced using data from private and government sources deemed to be reliable. The information herein is provided without representation or warranty.

Percentage of count derived from Carrier Route Geography<sup>[1]</sup> 94.9% 95.2% 97.8%  
 Percentage of count derived from Zip Code Geography<sup>[2]</sup> 5.1% 4.8% 2.2%

2000 Census Block Group Data and Geography, (SF3 release for Income, SF1 release for remainder, Average Income = Aggregate Income / Households).

<sup>[1]</sup> Delivery statistics are determined using Carrier Route Geography from GDT; if this level of geography is not available (usually in rural locations), <sup>[2]</sup> Zip Code Geography is used.